



AR Adjustable Trigger System



Operators Instruction Manual



2737 Nettle Ave. - Sheldon, IA 51201
Phone: 712-324-7409
Email: jardinc@excite.com - www.jardinc.com



This fire control system is intended for use only by experienced competitive shooters and professionals. You must take responsibility for your own actions. We will not be responsible for any loss, injury, or death resulting from the use or misuse of this product.

The handling and use of firearm bears with a certain unavoidable risks, like sky diving and rock climbing. If you are not willing to accept responsibility for your own actions, guns are not for you.

The use of any custom parts or modifications may void any warranty from the manufacturer of your firearm.

Returns will not be accepted on any parts that have been modified.

If you do not have a thorough understanding of the AR trigger system and the purpose and function of all the parts, do not attempt to install this system. Have it installed by an experienced gunsmith.

Read the instructions completely before beginning the procedure.

1. Remove the magazine and visually check the chamber before further handling the rifle, to verify that it is not loaded.
2. Remove the take down pins and separate the upper and lower assemblies.
3. With a plastic mallet and drift, remove the trigger pins and original trigger components (a plastic mallet and drift will prevent damage to the receiver). The original pins will be used in the installation of new system.
4. Remove the pistol grip from the lower receiver.
5. Remove the safety detent and detent spring, which were exposed from the removal of the pistol grip.
6. Remove the safety lever from lower receiver.
7. With a 1/8" hex key, install the 1/4"-28UNF x 1/2" socket set screw into the hole the pistol grip fastens to. Turn it up into the trigger assembly cavity until it protrudes into the cavity about 1/4". If this is not achievable the hole must be tapped further. Remove the screw for next step.
8. Disassemble and clean all threads, then apply Loctite to all screws to be used on the new trigger assembly.
9. Reassemble the new trigger assembly. Turn the three screws in the assembly until they are flush with the bottom of the part.
10. Hold the trigger assembly upside down and set the trigger return spring into the spring pocket on the bottom side of trigger assembly. Some kits may contain adjustment shims that need to be placed in the spring pocket, between the spring and trigger. (A different rate spring may be purchased from the factory).
11. While holding the trigger assembly upside down, lower the lower receiver onto the trigger assembly in an upside down manner also. (Instead of holding receiver upside down,

you can put a dab of grease into spring pocket, this will hold spring in place during assembly).

12. While holding the trigger assembly in the lower receiver, align and install the original trigger pin into the assembly.
13. With a 1/16" hex key, adjust the over travel set screw (the front screw on trigger assembly) so the hammer misses the sear edge while trigger is held in the fire position. (The hammer will need to be removed to access this screw).
14. Install the hammer and new hammer spring into the lower receiver using the original pin.
15. With a 1/8" hex key, install the 1/4"-28UNF x 1/2" socket set screw into the hole the pistol grip fastens to. This screw will be used as the sear engagement stop.
16. Place the hammer in the cocked position. With the 1/8" hex key, turn the sear engagement screw until the sear disconnects from the hammer. Then back off the screw about 7/8 turn. (This amount of travel and sear engagement is needed for semi-auto rifles. This will prevent double fires, for safe operation and less stress on trigger parts). (Small amounts of screw rotation makes large changes). **(Two stage units, disregard this step, the screw for this step is not included).**
17. While the trigger is in the cocked position, turn the disconnect screw (using a 5/64 hex wrench), so when in the cocked position you can push down on the hammer and feel it brush against the hook of the disconnect as much as possible without hooking. **(Two stage units, adjust so the disconnect contacts the hammer just prior to the trigger releasing the hammer).**
18. Install safety back into the lower receiver. Turn the safety so the flat portion is facing to the front of the lower receiver. The safety in this position allows access to the safety adjustment screw. With a 1/16" hex key, adjust the screw counterclockwise so there is NO movement of the trigger in the safety position, but still allowing for sear hammer disconnect in the fire position. (The safety detent, spring, and pistol grip may need to be slid into position to make the safety lever to track in the correct position)
19. Using the short pistol grip screw provided (1/4"-UNF x 1/2" flat head slotted machine screw), install the pistol grip. **(This screw is not provided in two stage kits).** Test adjustments by pulling up on the hammer in both the cocked position and in the disconnect position. If the hammer can be pulled out of position in either state, more engagement is needed.
20. Allow Loctite to dry for 24 hours before using.

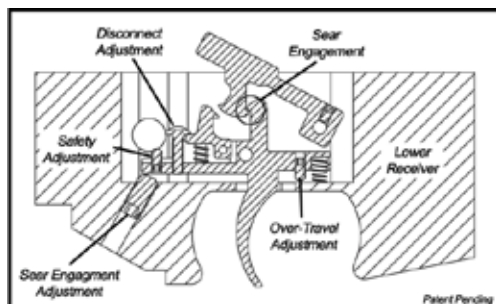

Trouble Shooting

Problem:	Solution:
After making all adjustments the trigger has no movement.	Review step #18, the screw must be turned <u>counterclockwise</u> to contact safety.
Double fires /Un-cocked hammer	Review step #17, give the disconnect as much contact with the hammer as possible without binding. Review step #16, give assembly more sear engagement. Remember whenever the sear engagement is adjusted the disconnect and safety screws MUST also be adjusted.
When adjusting the disconnect, the other adjustments (sear) seem to be incorrect, or when making disconnect adjustment, there is insufficient disconnect adjustment, or trigger becomes rigid.	Check if the disconnect adjustment screw protrudes too far below assembly and is contacting receiver. If this is the case, grind the screw shorter.

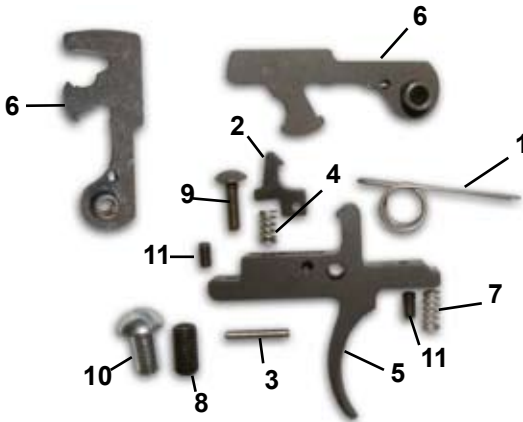

AR Single Stage Trigger Parts Breakdown List

Ref #	Part #	Description
1.	1010	Hammer Spring
-	1610	Hammer Spring Heavy
-	1255	Hammer Spring Extra Heavy
2.	1167	Disconnect Single Stage
-	1298	Disconnect Two Stage
3.	1009	Disconnect Pin
4.	1017	Disconnect Spring
5.	1002	Trigger (Small Pin)
-	1135	Trigger (Large Pin)
6.	1028	AR-10 Hammer
-	1136	AR Speed Hammer (Large Pin)
-	1001	AR Speed Hammer (Small Pin)
-	1133	AR Weighted Hammer (Large Pin)

Ref #	Part #	Description
-	1027	AR Weighted Hammer (Small Pin)
7.	1012	Trigger Return Spring (1-1/2#)
-	1013	Trigger Return Spring (2#)
-	1014	Trigger Return Spring (3#)
-	1015	Trigger Return Spring (4#)
-	1016	Trigger Return Spring (4-1/2#)
-	1017	Trigger Return Spring (5#)
8.	1004	Sear Engagement Screw
9.	1187	Disconnect Screw
10.	1005	Pistol Grip Screw
11.	1123	Over-travel/Safety Screw
-	1018	Spring Shim
-	1020	Loctite

JARD, Inc.

2737 Nettle Ave. - Sheldon, IA 51201

Phone: 712-324-7409 - Email: jardinc@excite.com

www.jardinc.com